

# Installation Guide

## Waterproof Junction Box

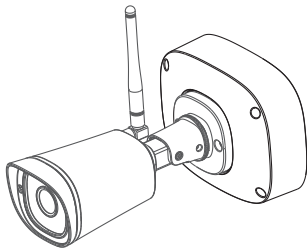

Model: FAB99

FAB99 is for Foscam Outdoor Mini Bullet IP Cameras,  
FI9900P FI9800P FI9900EP FI9901EP, etc.

Version: 1.0

1

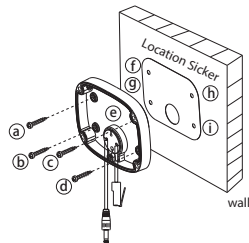

Screws: a b c d    Silica Gel Plug: e    Rubber Screw: f g h i

1. Put the Location Sicker on the wall and drill five holes, four for small and one for big.
2. Nail the rubber screws into the four small holes.
3. Thread wires through the big hole and the bottom cover.
4. Tighten the screws to fix the bottom cover.
5. Put the silica gel plug at the junction of bottom cover and wires.

2

Fix the Waterproof Junction Box on the IP camera

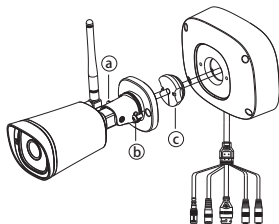

Silica Gel Plug: c    Screws: a b

1. Loosen the screws to open the Waterproof Junction Box.
2. Put the silica gel plug at the junction of camera and wires.
3. Thread wires through Waterproof Junction Box.
4. Tighten the two screws to fix camera on the Waterproof junction box.

3

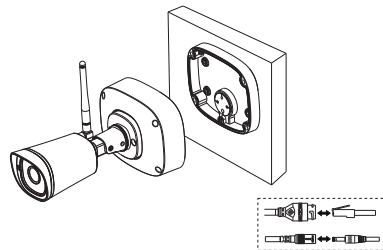

1. Connect the wires.
2. fix the wires to the Waterproof Junction Box.

4

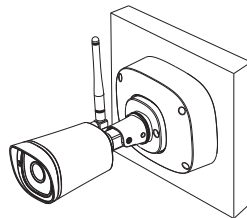

Tighten the screws to fix the Waterproof Junction Box and IP camera on the wall.